

# NAVIGATOR<sup>®</sup>

## Mobile USER GUIDE

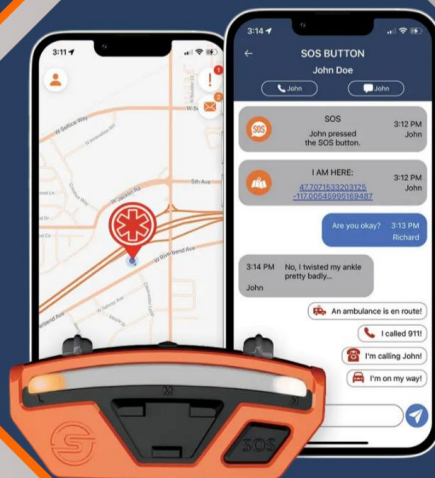
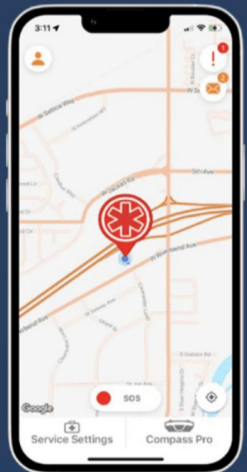

*COORDINATED  
COMMUNICATION WHEN  
EVERY SECOND COUNTS*

# Table of Contents

Installation & Setup .....3

Specifications .....3

    Navigator Mobile .....3

    Navigator Console.....3

    Privacy .....3

    Bluetooth Connection .....4

    Voltage & Current Tabs.....5

    Tools Tab.....6

Emergency Events.....7

    Automatically Created Emergency Events.....7

    Automatically Created Emergency Events Continued .....8

    Emergency Service Settings.....9

    Account Settings .....10

    Creating Your Emergency Response Team.....11

    Receiving an Emergency Event .....12

    Firmware Update Recovery.....13

Ordering Information ..... 13

End User License Agreement ..... 13

## Installation & Setup

To be able to take advantage of all the available features of your COMPASS series device connect it to the Navigator Mobile Apps. The Safeguard Navigator Mobile Apps are free for download from the Apple App Store (iOS) and Google Play Store (Android). After downloading, follow the in-App prompts to set up and create an account profile.



<https://www.safeguardequipment.com/compass-pro-quick-start-guide>

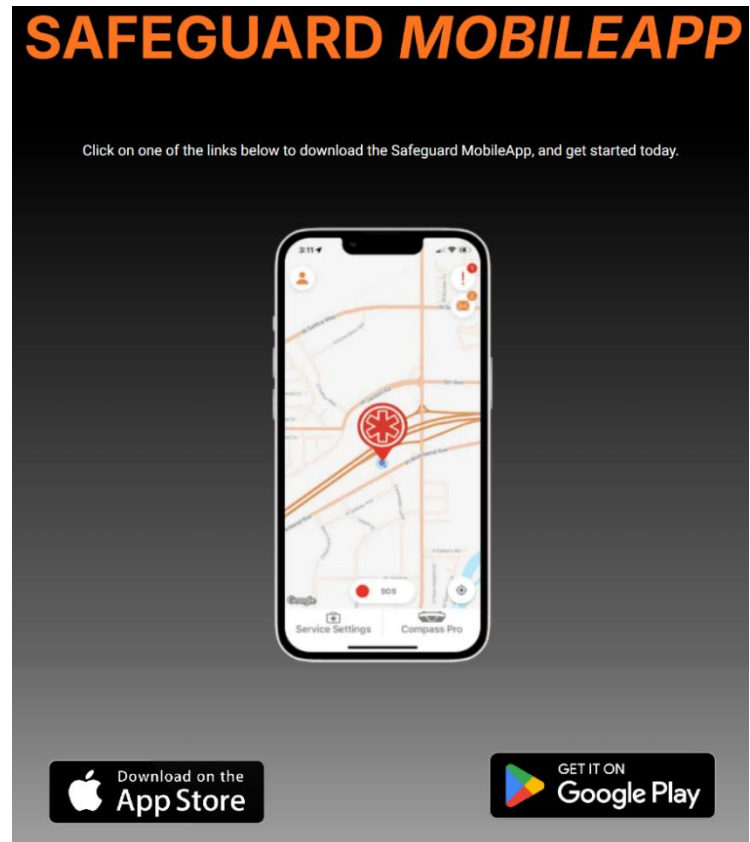

## Specifications

### Navigator Mobile

Operating System	Minimum Requirement
Android	Android 7.0
IOS	IOS 15.0

### Navigator Console

See the Navigator Console User Guide for details.

<https://www.safeguardequipment.com/webapp-user-guide/>

### Privacy

For privacy information regarding the Navigator Mobile & Navigator Console Apps please see our Privacy Policy.

<https://www.safeguardequipment.com/privacy-policy-apps/>

## Bluetooth Connection

To connect your Compass Series device tap the COMPASS Pro tab. The following orange screen will display. Ensure your COMPASS series device is powered on and held near your phone to pair. Bluetooth pairing should occur within several seconds. The COMPASS series device will display sweeping green LED's to indicate pairing.

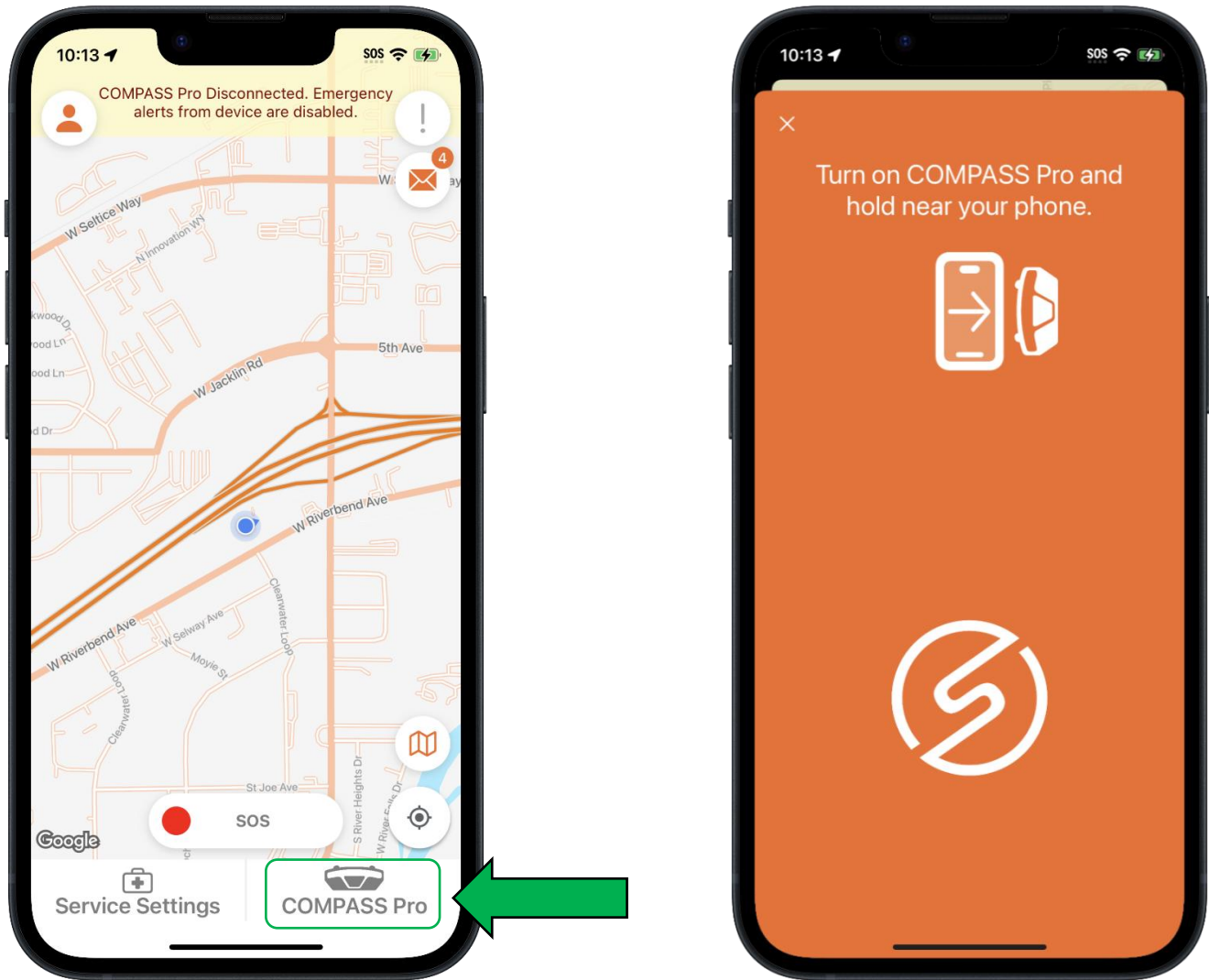

Once paired and connected if there is a device firmware update available, you will see a prompt from the App asking to update the firmware. It is always advised to update the firmware as the updates provide functionality improvements and new features.

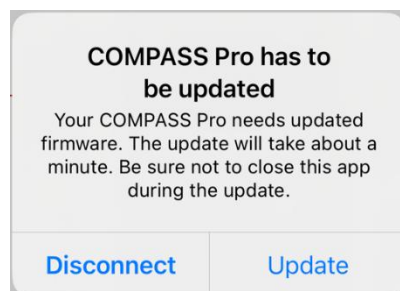

Ensure your phone stays on with the app open for the duration of the update. If the update process fails, please see the troubleshooting section for recovery instructions.

## Voltage & Current Tabs

Next the screen will change to one with several tabs (Voltage, Current, Tools). The COMPASS series battery level is also shown at the top of the screen.

An Alert Level line is displayed on each tab, this is the threshold the COMPASS series device will begin alerting at for that detection method (voltage or current).

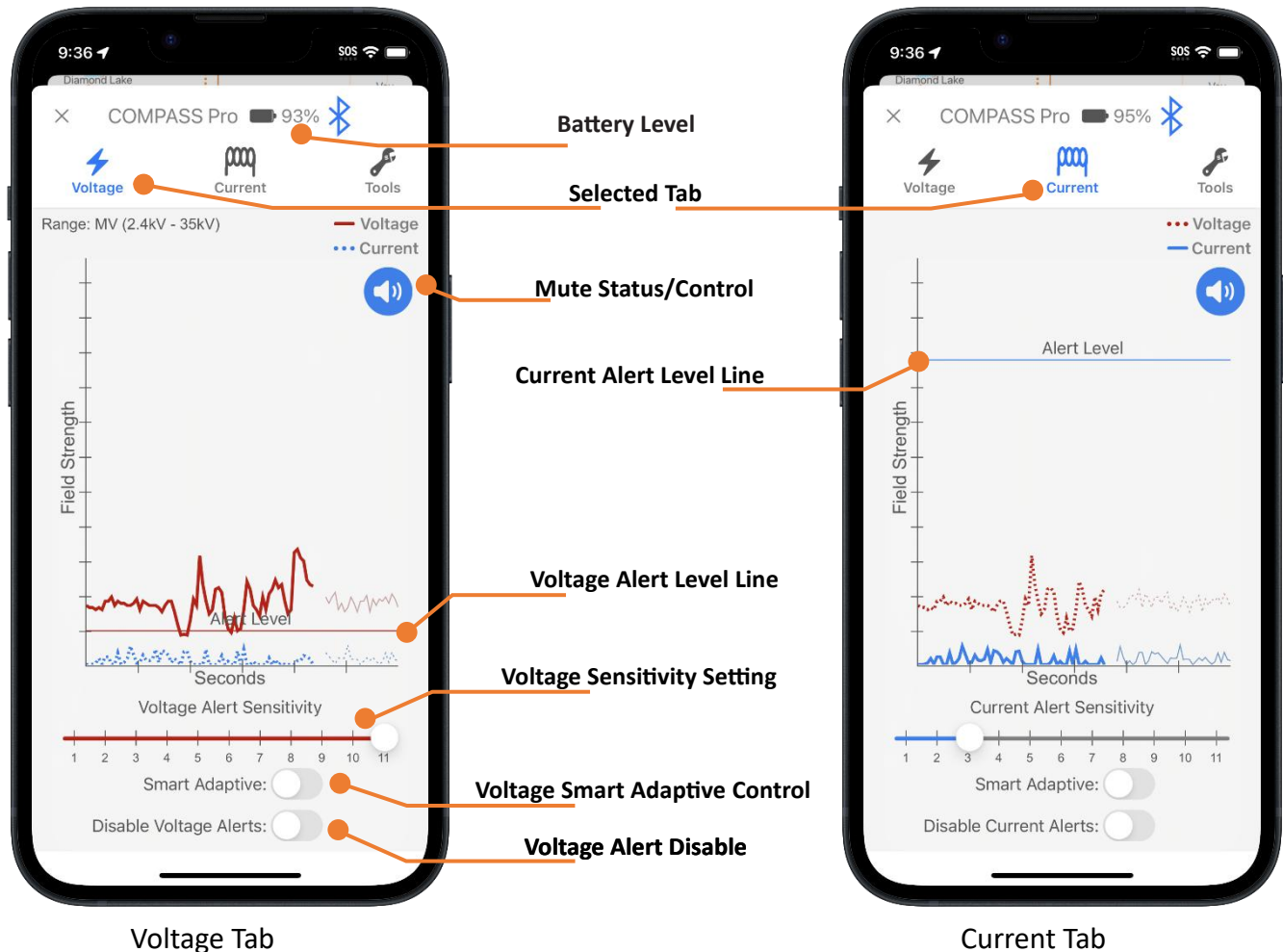

### Sensitivity Setting

The sensitivity setting affects the location of the Alert Level Line and when the device provides audible and visual alerts to the wearer for that detection method (voltage or current). See the Compass Series User Guide for more information on what effect different settings have around different sources.

### Alert Disable

The alert method (voltage or current) can be disabled with this toggle.

### Smart Adaptive

Enabling the smart adaptive mode changes the alert mode for that detection method (voltage or current). For more information see the smart adaptive mode section of the Compass Series User Guide.

### Mute

The Compass series device can be muted/unmuted using this toggle.

## Tools Tab

The tools tab gives status and adjustment of some additional COMPASS series device settings.

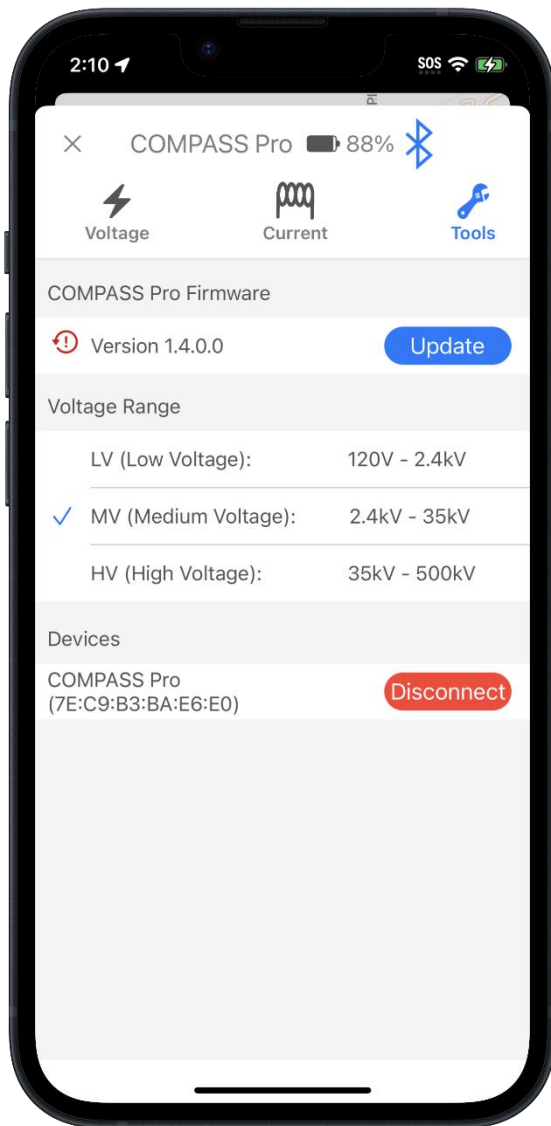

### Compass Series Device Firmware Version

If the firmware version is outdated, an option will be available here to update it.

### Voltage Range

Certain COMPASS series devices have three (3) selectable voltage ranges for maximum versatility. Each range is tailored to work well around a certain span of source voltages. See the Compass Series User Guide for more detail.

### Devices

Identifies the currently connected COMPASS series device. A disconnect option is available to unpair/disconnect from the current device to be able to connect to a different device.



## Emergency Events

Most emergency event features are only available with a service subscription. The below matrix describes the features you receive with and without a service subscription.

Description	No Subscription	Subscription
Compass series voltage/current settings	✓	✓
Receive emergency event SMS messages	✓	✓
Detect and send emergency events	✗	✓
Emergency map + chat features	✗	✓
Receive emergency event notifications	✗	✓
Compass series configurations & administration (see WebApp)	✗	✓

### Automatically Created Emergency Events

All automatically created emergency events start a 30 second countdown. When the countdown expires an emergency event is created and the user's emergency contacts are notified.

The countdown can be expedited via the CONFIRM slider in the app, or by holding the COMPASS series device SOS button.

The countdown can be canceled via the CANCEL slider in the app, or by holding the COMPASS series device MAIN button.

After an emergency event is created, it can only be canceled in the app.

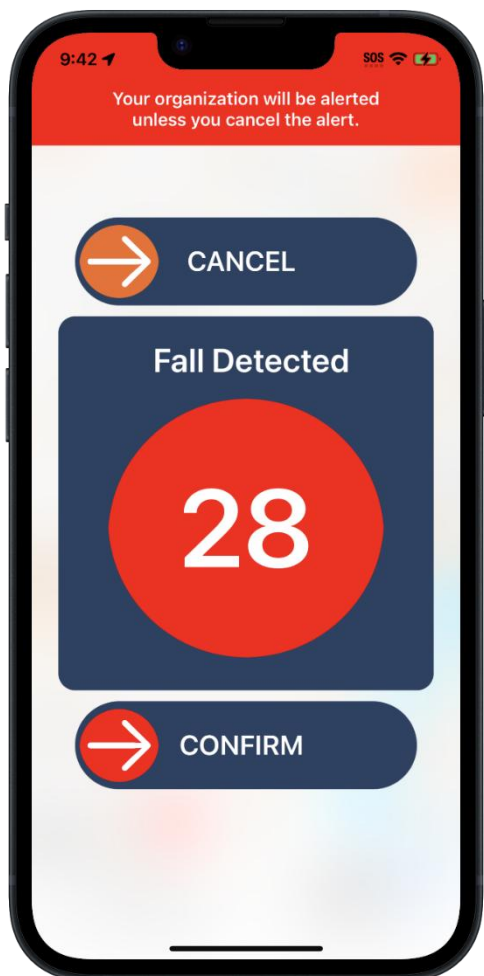

Emergency Event Countdown

## Automatically Created Emergency Events Continued

### Impacts



An impact event is generated when:

The COMPASS series device is appropriately mounted on a hard hat (see mounting instructions).

The impact is in a downward direction.

The force of the impact experienced is enough that it could cause a concussion.

### Falls



A fall event is generated when the COMPASS series device experiences a 6ft (1.8m) fall.

### Arc Flash



An arc flash event is generated when the COMPASS series device detects light characteristics of an arc flash severe enough to cause injury.

### No Motion Detected / Man Down



When no motion is detected by the COMPASS series device for 60 seconds following the initiation of an emergency event this is added to elevate the urgency of the emergency event. An additional notification will be sent to the user's response team. No movement does not trigger an event by itself.

## Manually Created Emergency Events

### SOS



An SOS event is triggered when the user presses and holds the SOS button on the COMPASS series device or the in-App SOS button for 3 seconds.



## Emergency Service Settings

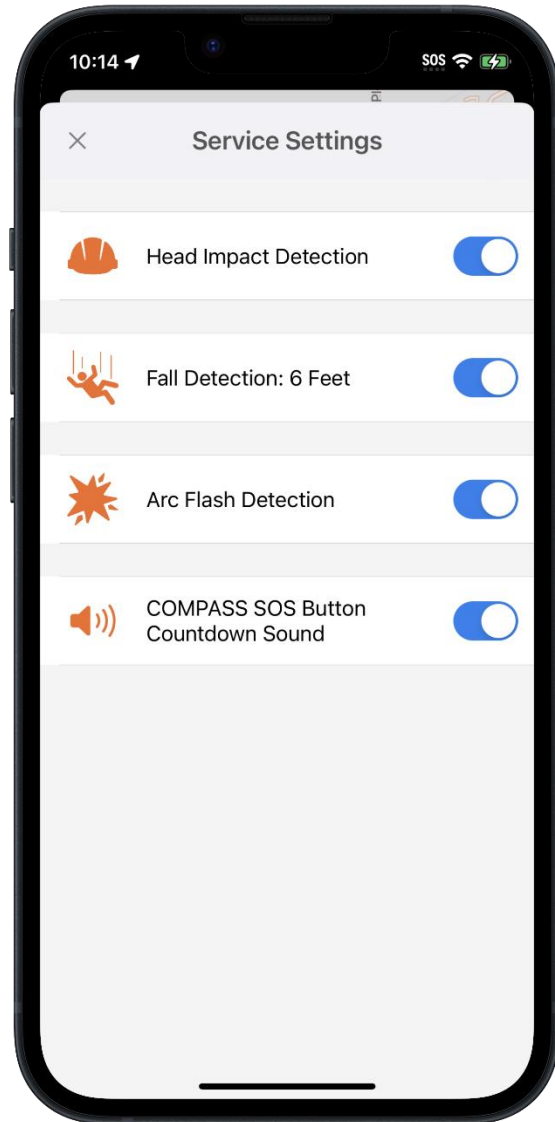
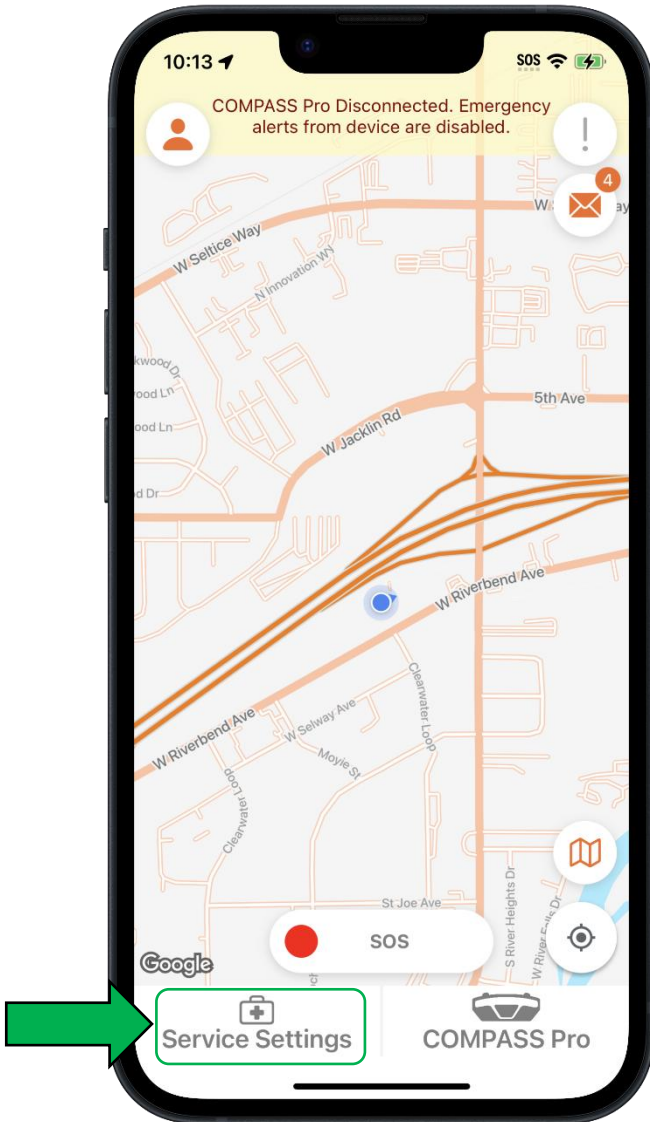

### Compass SOS Button Countdown Sound

If this option is disabled (as shown) the COMPASS series device will not make a countdown sound as you are holding the SOS button (3 seconds). This turns the SOS button feature into something that can be triggered discreetly.

### Head Impact Detection

Toggle to enable/disable this emergency event.

### Fall Detection

Toggle to enable/disable this emergency event.

### Arc Flash Detection

Toggle to enable/disable this emergency event.

## Account Settings

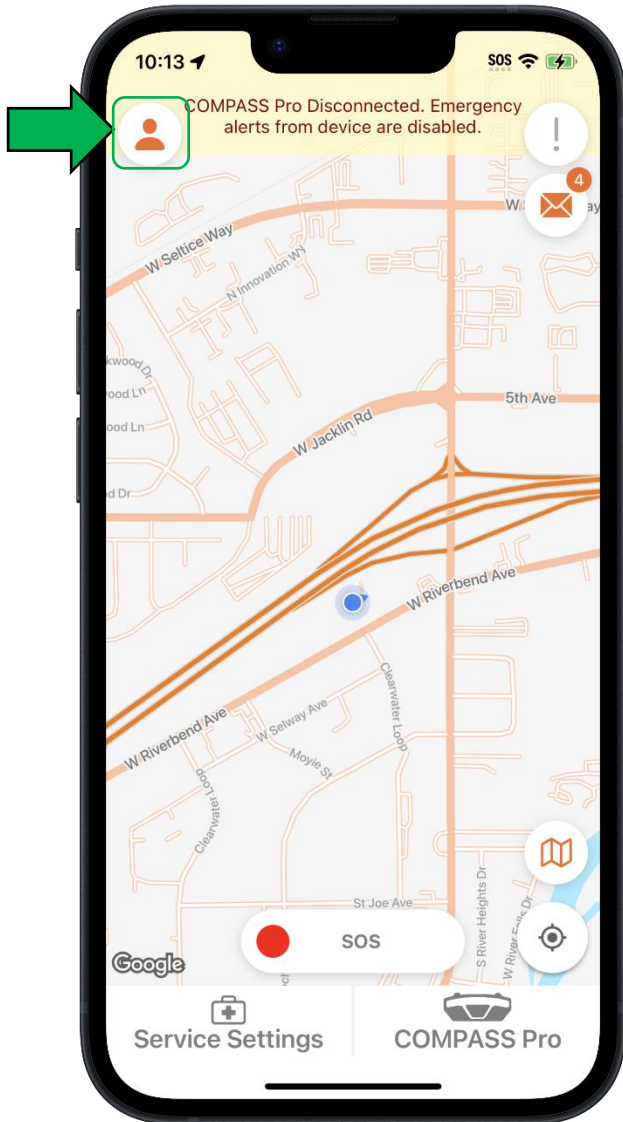

### Add Emergency Contact

### Existing Emergency Contacts

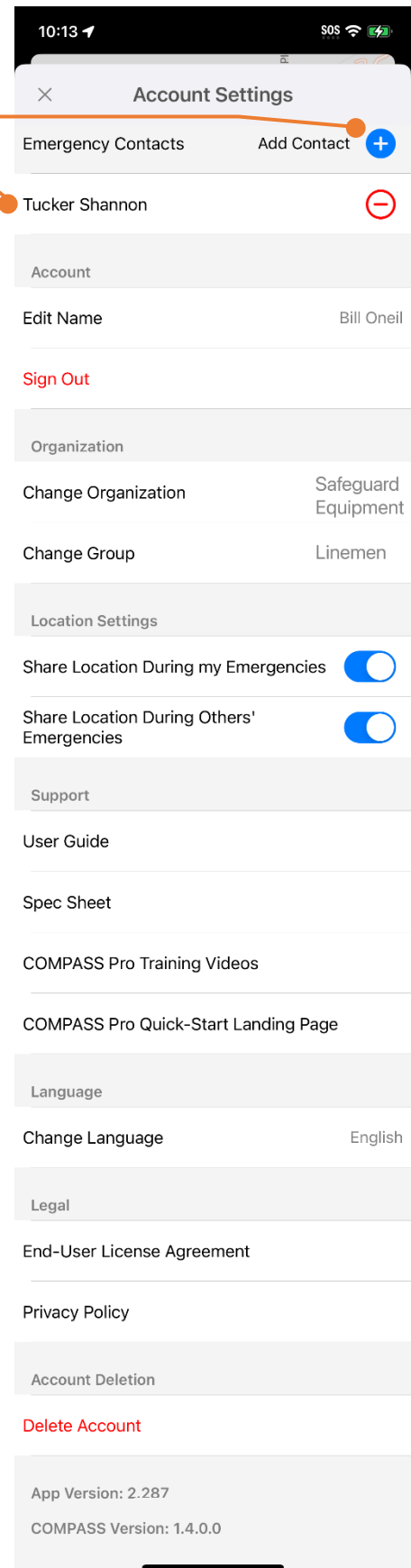

The account settings page gives access to various settings, such as setting your name, app language, as well as support resources such as the Compass Series User Guide and training videos.

Users can set their emergency contacts (who is notified when they trigger an emergency) from this page. See the “Creating Your Emergency Response Team” section below.

If you have a subscription to Navigator, there are settings here to join or change the organization you are part of and adjust additional location sharing permissions for emergency events.

## Creating Your Emergency Response Team

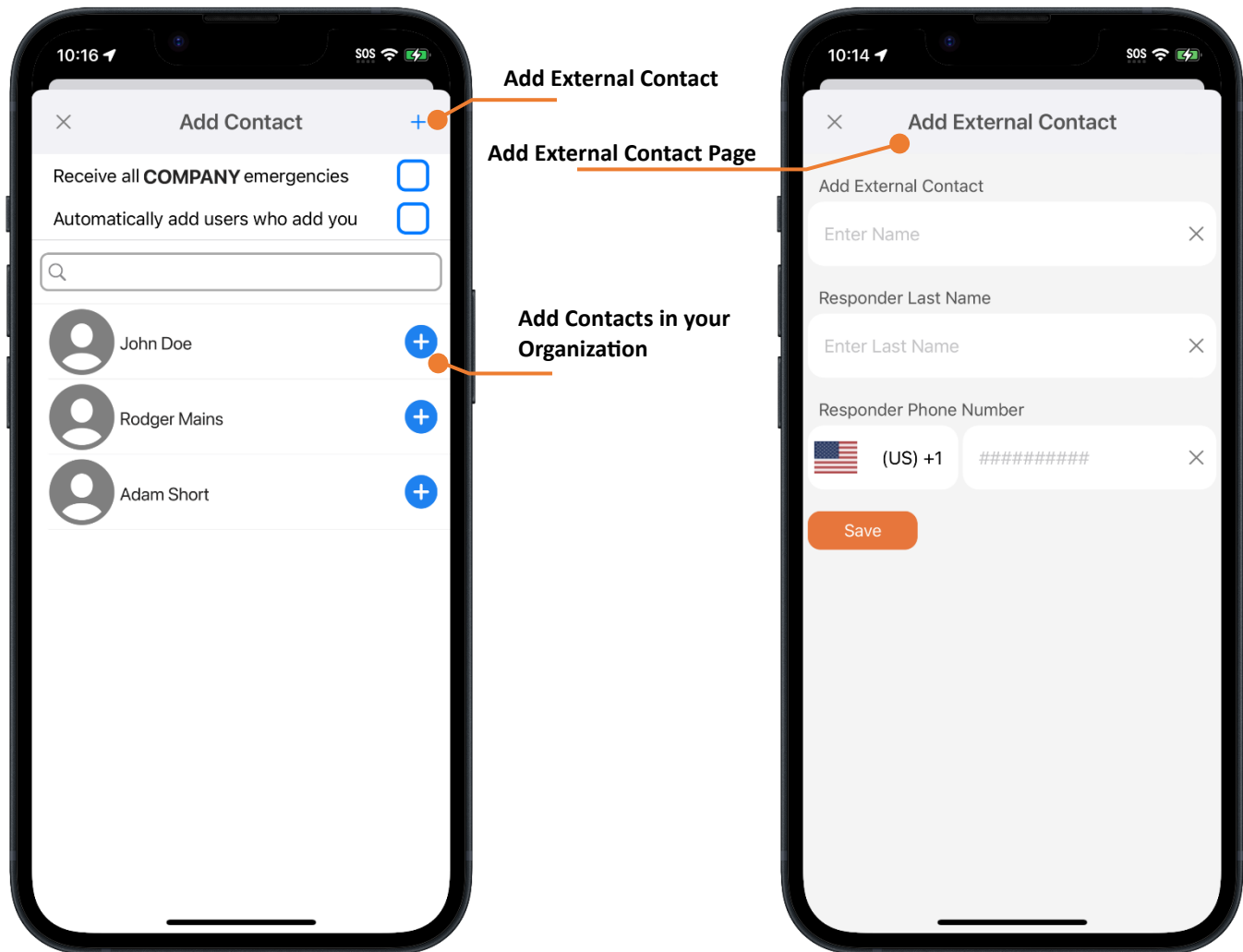

After clicking the Add Contact button from the Account Settings page, a new window appears that lets users configure their emergency response team.

Contacts within your organization are listed and can be added with one press.

External contacts can be added by pressing the + icon and then manually inputting their name and contact phone number.

In-organization contacts with a subscription to Navigator receive more sophisticated emergency event information via App push notifications and additional SMS messages. External contacts only receive SMS messages.

## Receiving an Emergency Event

When an emergency event is generated, notifications are pushed to the designated responders. In addition, SMS messages and an in-App emergency response chat are initiated for multiple redundant communication paths ensuring the delivery of the event information and coordination of the response. The in-app emergency response chat contains all users who are set as emergency contacts, ensuring a coordinated response. Information such as the type of event and users' current location are shared on the map/messages if available.

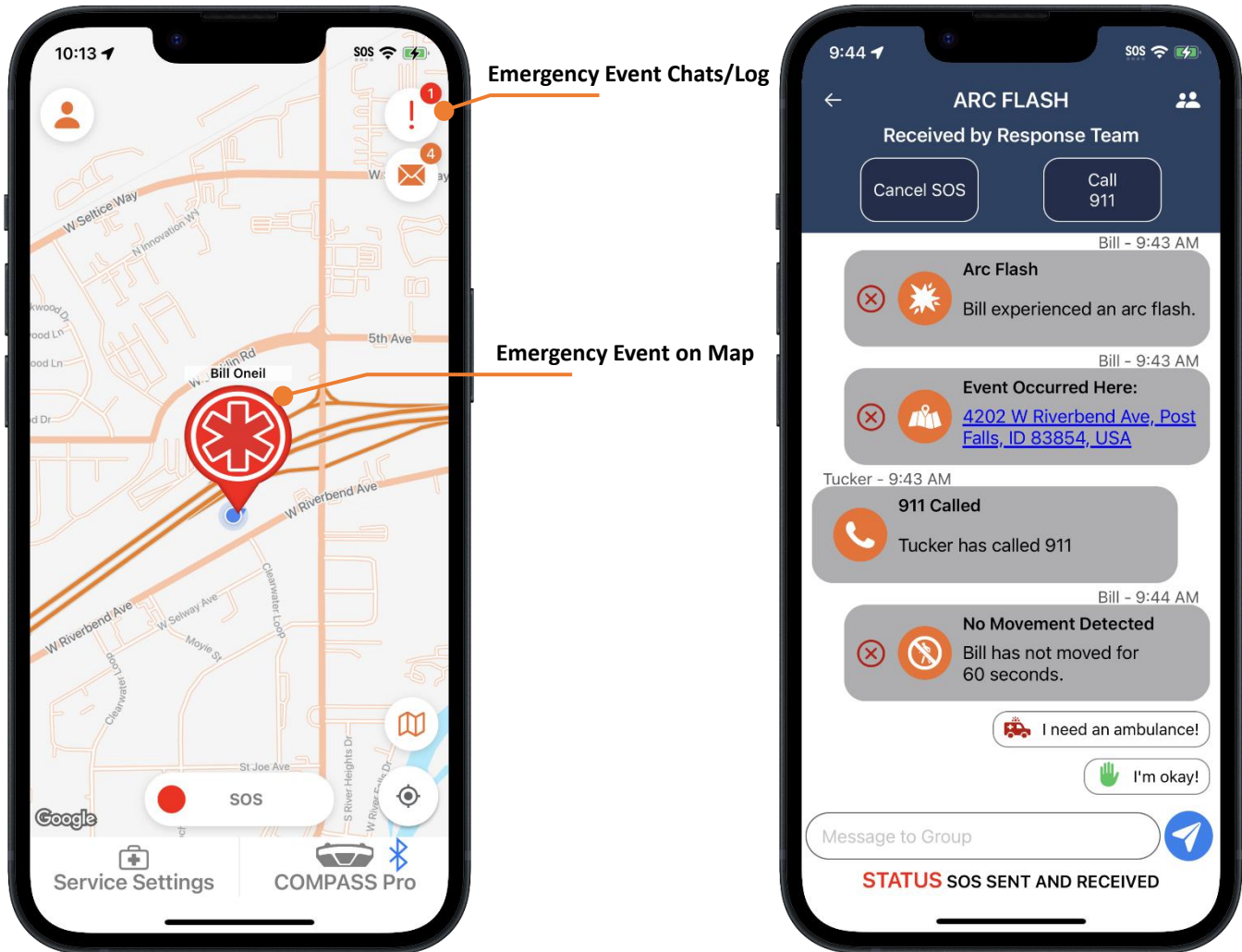

When an emergency event is triggered and you are configured as a responder, you will receive the following:

- A critical alert push notification with event details and a link to the emergency response chat. This overrides the phones "silent" feature, ensuring message delivery.
- SMS text containing event details and user's location.
- If you are using a Compass series device, the device will flash corner lights ORANGE/WHITE three times with an accompanying tone. The Compass series device heartbeat is replaced with ORANGE/WHITE flashing until you check the emergency response chat.

## Firmware Update Recovery

If the COMPASS series firmware update process fails, your COMPASS series device may not display lights or operate normally. Your COMPASS series device is recoverable by performing the following steps.

1. Launch Navigator Mobile.
2. Tap the COMPASS Pro tab. The following orange screen will display. Hold the COMPASS series device near the phone. Pairing should occur within a few seconds. The COMPASS series device may not display any lights or give any feedback during this process.

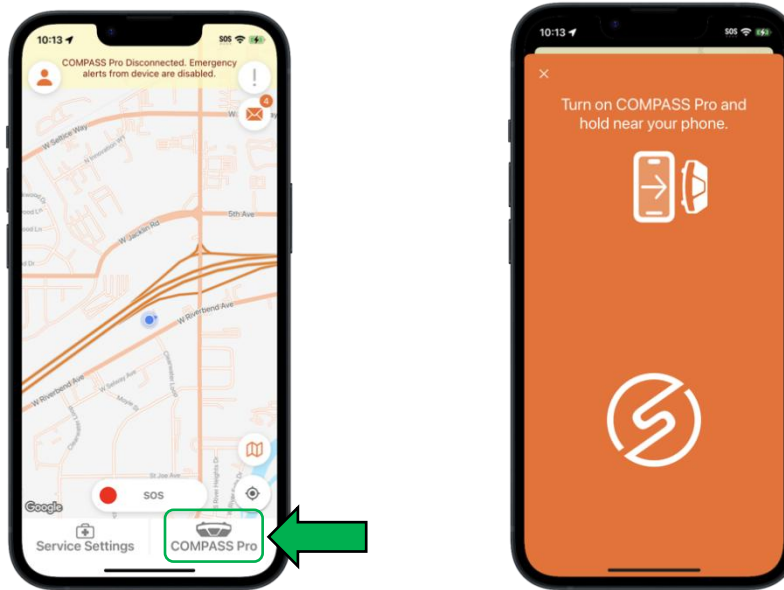

3. Once connected, the app will recognize the COMPASS series device needs recovering and will issue the following prompt.

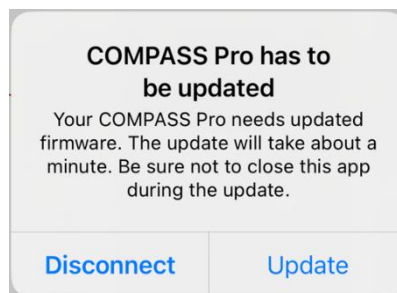

4. Tap "Update". Ensure the phone stays on with the app open for the duration of the update.
5. If your COMPASS series device does not pair/connect try connecting to a USB charger and allow to charge for 15 minutes before trying again.

## Ordering Information

Part#	Description
SERVICE	Subscription Service

For all device and software subscription sales please contact us at [sales@safeguardequipment.com](mailto:sales@safeguardequipment.com)

## End User License Agreement

Please see the Safeguard Equipment End User License Agreement for terms and conditions.

<https://www.safeguardequipment.com/end-user-license-agreement/>